

Exhaust

Atlantic British should be your first and only source for exhaust parts for your Discovery. We have everything from clamps to catalytic converters to complete systems. They are easily shipped, easily installed and easily the best performing exhausts you can buy. Our complete packages come with everything you need—pre-fitted and custom-manufactured for your Discovery—so it fits right the first time. And both of the stainless steel exhausts offered here are guaranteed to last the life of your Rover!

Borla Performance Stainless Steel Exhaust

The best exhaust system you can buy for your Rover, for several reasons. Aircraft-quality T-304 stainless steel construction is lighter and stronger than conventional steel and is used inside and out (not just a stainless coating). It's fully welded without crimping for unimpeded flow-through, with slip-fit connectors for an easy, secure fit. Maintenance-free sound absorbing materials maintains low dBs, protects against burnout and reduces shell temperature. And each Borla exhaust is precision-tuned to your vehicle to actually improve engine performance. GUARANTEED for 1 million miles—the best in the business! Legal in all 50 states. It all adds up to make this the last exhaust system you'll ever buy for your Rover!

Borla Stainless Steel Exhaust System - Discovery I (9927)

Falcon Performance Stainless Steel Exhaust

If you want a high-performance, stainless steel exhaust without the "high-performance" sound, the Falcon is your best choice. All Mandrel bends insure free flow of exhaust gases, with no backups or gaseous odors, and the top-quality stainless steel exterior is guaranteed for the life of your vehicle. The Falcon has it all: a quiet, high-performance, custom-fit stainless steel exhaust at a price less than the soft steel OEM system! Easily installed at your local garage.

Falcon Stainless Steel Exhaust - Discovery I (9933)

ILL No.	Part No.	Description	Qty. Rqd.
---------	----------	-------------	-----------

EXHAUST

REMARKS LEGEND -

Vehicle i.d. (v) numbers:

SA = 1995 model year; TA = 1996 model year

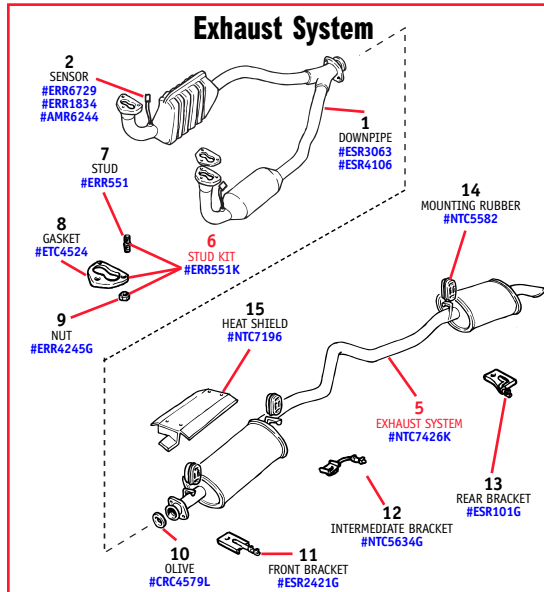

1	ESR3063	DOWN PIPE, with catalytic converters ('Y' pipe) Through (v) SA135999; not advanced evap. loss models	1
	ESR4106	DOWN PIPE, with catalytic converters ('Y' pipe) From (v) TA194200 and TA525034 through TA534103 and TA703236; not advanced evap. loss models	1
2	ERR6729	SENSOR, heated oxygen	2
	ERR1834	SENSOR, heated oxygen	4
	AMR6244	SENSOR, heated oxygen	4
3	9933	EXHAUST SYSTEM, complete kit, Falcon stainless	1
	9927	Includes centre and rear mufflers, plus clamps EXHAUST SYSTEM, 'Borla' High Performance, stainless	1
5	NTC7426K	Single muffler system EXHAUST SYSTEM, complete kit, standard	1
		Through (v) TA166329 and TA502742; includes centre and rear muffler, plus clamps	
6	ERR551K	STUD KIT, exhaust manifold	2
		Includes items 8 - 10 for one manifold	
	EXHBC	EXHAUST BAND CLAMP, for Stainless Steel Exhaust Systems	*NLA
7	ERR551	STUD, manifold to down pipe	6
8	ETC4524	GASKET, manifold to down pipe	2
9	ERR4245G	NUT, manifold to down pipe, Genuine	6
10	CRC4579L	OLIVE, down pipe to exhaust system	1
11	ESR2421G	BRACKET, support, front, Genuine	1
12	NTC5634G	BRACKET, support, intermediate, Genuine	1
13	ESR101G	BRACKET, support, rear, Genuine	1
14	NTC582	MOUNTING RUBBER	3
15	NTC7196	HEATSHIELD, exhaust	1

ILL No.	Part No.	Description	Qty. Rqd.
---------	----------	-------------	-----------

Exhaust Manifolds

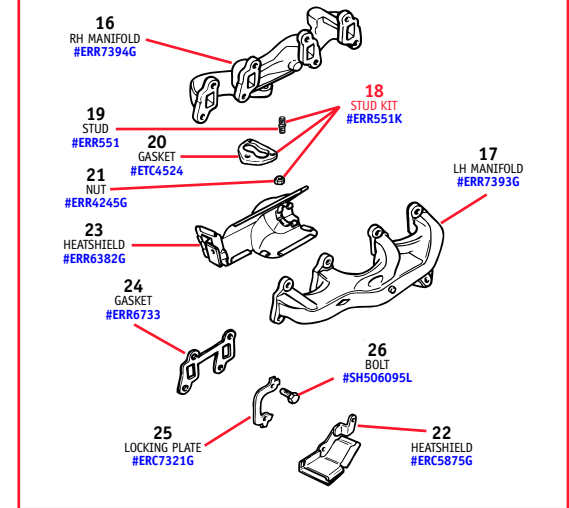

16	ERR7394G	EXHAUST MANIFOLD, RH	1
17	ERR7393G	EXHAUST MANIFOLD, LH, Genuine	1
	EMFKD1A	FIXING KIT, manifold	*NLA
		1994 through 1995 model year, (e) 35D, 36D	
	EMFKD1B	FIXING KIT, manifold	*NLA
		1996 through 1997 model year, (e) 50D	
	EMFKD2A	FIXING KIT, manifold	*NLA
		1998 through 1999 model year, (e) 50D	
18	ERR551K	STUD KIT, exhaust manifold	1
		Includes items 19-21 for one manifold	
19	ERR551	STUD, manifold to down pipe	6
20	ETC4524	GASKET, manifold to down pipe	2
21	ERR4245G	NUT, manifold to down pipe, Genuine	6
22	ERC5875G	HEATSHIELD, starter motor, Genuine	1
		(e) 35D, 36D engines	
23	ERR6382G	HEATSHIELD, starter motor, Genuine	1
		(e) 50D engines	
24	ERR6733	GASKET, exhaust manifold	4
25	ERC7321	LOCKING PLATE, exhaust manifold	8
26	SH506095L	BOLT, exhaust manifold	16
		Not flanged type	

*NLA = No Longer Available

TECH TIP: Oxygen Sensors & Emissions System



Need a new oxygen sensor? You need to know your vehicle's emissions system 'Evap Family' identification to determine the right sensor to order. See the 'Emissions Systems' tech tip on page 33 for more details and give us a call.